

Photo by Heather Swartz

# WILDFAIR

Wildfair—the 2025 Mansion in May—has a rich history going back more than 220 years.

Before it was first turned into a picturesque and gracious country estate in 1934, the Chester Township property had long been a working farm and the site of a gristmill, sawmill, and workshop for the manufacture of millstones.

In 1804 a deed conveying the property from Elias and Nancy Howell to Peter Dorland indicated that a mill was already established there on a pond fed by the upper reaches of the Peapack Brook. Dorland, who was a miller by trade, had been a fier in the New Jersey militia during the Revolutionary War. For most of the next seventy years, until 1876, the farm and gristmill were operated by various members of the Dorland family.

In 1934, Elizabeth Wolcott Elkins, daughter of a prominent Philadelphia banker, and her husband, Harry Bowly Hollins III, a New York banker and broker, acquired the property from John P. Ike, a local builder. The Hollinses soon hired the Philadelphia architectural firm of Willing, Sims & Talbutt to design their new country estate. The architects retained the original late eighteenth- or early nineteenth-century stone farmhouse and designed extensive fieldstone additions to create a rambling and spacious country retreat the Hollinses named Wildfair. The Colonial style of the house was enhanced by small-pane casement windows and French doors and bay windows that faced the pond behind the house.

Elizabeth Elkins Hollins, known as “Ibbie,” was a first cousin, close friend, and sometime rival of one of the leading American interior decorators of the twentieth century, Dorothy May Kinnicutt Parish, better known as Sister Parish. Sister, who grew up at Mayfields, the Kinnicutt family country estate (extant) in nearby Far Hills, had been the matron of honor at Ibbie Hollins’s

June 1931 wedding, and only four months before Ibbie had been Sister’s maid of honor at her wedding to Henry Parish II. It is likely the two cousins—who for years also both summered at Dark Harbor on Islesboro Island, Maine—worked together to plan the interior of Wildfair, as Sister had recently opened up her first small decorating shop near the train station in Far Hills, hanging out her first sign, “Mrs. Henry Parish II—Interiors.”

Shortly after World War II, the Hollinses divorced and each remarried, and Wildfair was sold to Elizabeth McEvers Cutting and her second husband, Nevil Jay Booker. Elizabeth Cutting, a descendant of Robert Fulton, developer of the steamboat, was the sister of Charles Suydam Cutting, a long-time resident of the Somerset Hills and a prominent naturalist, explorer, author, and accomplished athlete in the ancient game of court, or “real” tennis. It was at the invitation of the Dalai Lama that Cutting, in the early 1930s, was among the first Westerners to be permitted entry to the so-called forbidden city of Lhasa in Tibet. Cutting is also credited with introducing the Lhasa Apso dog breed to the United States. The dogs had been a gift to Cutting by the 13th Dalai Lama.

Elizabeth Cutting Booker, who outlived Nevil by some twenty-seven years, died in 1980 at age ninety-five. The next year, Wildfair was sold to Orin Robert Smith, who a few years later was named president and chief executive officer of the Engelhard Corporation.

In the mid-1990s, a subsequent owner of the property retained architect Hiland Hall Turner and Eberle Builders, Inc. to design and construct extensive additions and alterations to the house, creating the beautiful, rambling country estate we see today.

W. Barry Thomson

# Women's Association for Morristown Medical Center's 2025 Mansion in May Beneficiary



## **New Proton Therapy Center at Morristown Medical Center** *Changing the Landscape of Cancer Care*

Proton therapy is an advanced cancer treatment that targets a patient's tumor with sub-millimeter precision. It deposits a high dose of radiation directly in the tumor and then stops, selectively destroying cancer cells and leaving healthy cells intact. Proton therapy has several proven clinical benefits, most notably its precise targeting of a tumor while preserving healthy tissue. It is especially beneficial for patients with head and neck cancer, brain tumors, as well as liver, lung and prostate cancer. It is also used for women with left-sided breast cancer, as proton therapy can protect the heart from damage.

### **Proven Clinical Benefits**

- Proton therapy is performed on an outpatient basis and takes a few minutes per session. It is non-invasive and painless, and patients can continue with normal activities during treatment.
- Proton radiation has a very short life once inside the body, and patients can leave the treatment room without any risk of radiation exposure to others.
- Proton is vital in treating children where local control is essential to prevent secondary cancers or minimize long-term side effects.

### **First-in-World Technology at Morristown Medical Center**

The MEVION S250-FIT Proton Therapy System™ will be **unveiled at Morristown Medical Center's Carol G. Simon Cancer Center in 2025\***.



The Proton Therapy Center at Morristown Medical Center will support all Atlantic Health System hospitals in northern and central New Jersey.

\*The MEVION S250-FIT Proton Therapy System is not yet available for clinical use.

## Technology Highlights

The MEVION S250-FIT is game-changing. It is the **first proton technology** to combine:

- A compact footprint with a fixed proton beam for more precise targeting. Instead of revolving around the patient, the unit moves the patient up and down.
- An innovative semi-upright chair positioning system that enhances patient comfort and treatment outcomes.
- A built-in, diagnostic-quality CT scanning system to verify organ positioning that help physicians adjust the treatment plan as needed and reduces side effects.

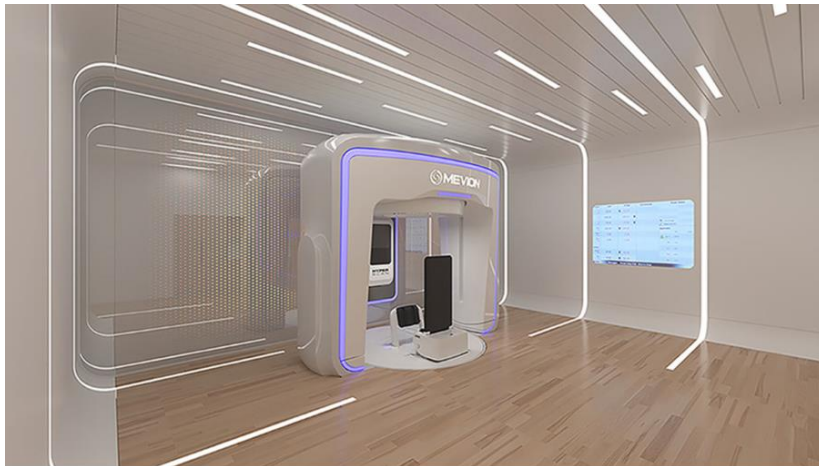

**MEVION S250-FIT**

The MEVION S250-FIT is scheduled to be installed at Morristown Medical Center's Carol G. Simon Cancer Center in 2025. Once in use, it will usher in a new era of cutting-edge radiation oncology service.

### Beneficiary Information

All proceeds from Mansion in May will support the new Proton Therapy Center at Morristown Medical Center. For more information, please visit [mansioninmay.org](https://mansioninmay.org).





**MANSION IN MAY**<sup>®</sup>

*designer showhouse and gardens*

2025

**WILDFAIR**

**THE WOMEN'S ASSOCIATION FOR MORRISTOWN MEDICAL CENTER**

*PROUDLY PRESENTS*

**THE 21st MANSION IN MAY**

**Location:** Wildfair, Chester Township, NJ

**Proceeds to Benefit:** The new Proton Therapy Center at Morristown Medical Center

**Mansion Open to the General Public:** Monday, May 1 - Wednesday, May 31.  
Open daily from 10am - 4pm, Last entry at 3pm

**Ticket Prices:** \$55 if purchased on or after May 1st.  
\$50 if purchased prior to May 1st.

**Private Guided Tours:** For details, visit [mansioninmay.org/tickets](https://mansioninmay.org/tickets)

**Parking:** Free shuttle service provided from 82 W Main Street, Mendham NJ 07945  
No parking available at Wildfair

**Mansion Email:** [info@mansioninmay.org](mailto:info@mansioninmay.org)

**Website:** [mansioninmay.org](https://mansioninmay.org), [wammc.org](https://wammc.org)

**Social Media:** Facebook and Instagram @mansioninmay

**Please Note:**

- Infants and children under 10 years of age are not permitted to visit the Mansion
- The Mansion is not handicapped accessible
- A curated selection of Boutiques available for shopping
- Café on site serving box lunch
- Designer sales items available. If you see it, love it, buy it



**50 YEARS OF IMPACT**

<b>YEAR</b>	<b>MIM LOCATION</b>	<b>CAUSE</b>	<b>FUNDS RAISED</b>
1974	Upton Pyne, Bernardsville	New ICU and CCU	\$133,000
1976	Giralda, Madison	Friends Fund of MMH	\$270,000
1980	Schiff Estate, Mendham	New OB/GYN Units	\$231,000
1981	Hollow Hill Farm, Convent Station	Special Care Nursery-Clinic	\$200,000
1986	Evergreens, Morristown	Cardiac Rehab Extension	\$127,000
1988	Warren Estate, Bernardsville	Telemetry Unit for Cardiac Surgery	\$350,000
1991	Upton Pyne Revisited, Bernardsville	ER Renovation	\$450,000
1994	Bayley-Ellard, Madison	Carol G. Simon (Women’s Cancer Center)	\$325,000
1997	Vail Mansion, Morristown	Carol G. Simon (Women’s Cancer Center)	\$325,000
1999	Knox Hill, Morris Township	The Children’s Medical Center	\$410,000
2001	Ellerslea, Morris Township	Goryeb Children’s Hospital	\$460,000
2003	Cross Estate, Bernardsville	NICU	\$662,000
2006	Ross Family Farm, Basking Ridge	Gagnon Heart Hospital	\$610,000
2008	Froh Heim, Far Hills	Valerie Fund Children’s Center at Goryeb Children’s Hospital	\$585,528
2010	Fawn Hill Farm, Harding Township	Emergency Department Expansion	\$810,000
2012	Glynallyn, Morris Township	Hospice & Palliative Care Center	\$1,326,88
2014	Blairsden, Peapack-Gladstone	PICU & Autism Center at Goryeb Children’s Hospital	\$2,000,000
2017	Alnwick Hall-The Abbey, Mendham Borough	Center for Nursing Innovation & Research	\$1,502,000
2020	Tyvan Hill, New Vernon	Gagnon Cardiovascular Institute - 5th Floor Expansion	\$1,000,000
2023	Three Fields, Morris Township	Gagnon Institute of Bioskills Training and Innovation	\$1,650,000
			<b>\$13,427,414</b>



# MANSION IN MAY®

*designer showhouse and gardens*

2025

SPACE #	TITLE	ROOM	INTERIOR DESIGN FIRM	INTERIOR DESIGNER
1	Soteria	Foyer	Broadfoot & Broadfoot	Scott Broadfoot
2	Cascade	Foyer Rt Hall & Under Stairs	Summit Rug Artistic Interiors by Jessica	Kazem Fatahi Jessica Teeling
3	Soteria	Front Right Hall	Broadfoot & Broadfoot	Scott Broadfoot
4	I Take My Whiskey Neat	Office	Elements Interior Design Studio	Marty McDevitt Joanne Turner
5	Heritage Haven	Marble Powder Room	Adina Kornbluth Designs	Adina Kornbluth
6	A Celebration of a Life Well Lived	Living Room	Barbara Ostrom Associates	Barbara Ostrom
7	The Wanderer's Library	Upper & Lower Library	Karla Trincanello - Interior Decisions, Inc.	Karla Trincanello
8	The Dining Room	Dining Room	Kristin Ashley Interiors	Kristin Badolato
9	Fanfare at Wildfair	Butler's Pantry	Robinwood Kitchens Sonja Gamgort Design	Rebecca Mahoney Sonja Gambort
10	The Found Out	Kitchen Powder Room	Plume Interiors	Dana Hunkele
11	Chester Woods Idyllic	Great Room	CWI Design	Rachel Kapner
12	SHOKUKAI - (Food Gathering)	Kitchen	Pam Epifano	Pam Epifano
13	Meet Me At The Orangerie	Breakfast Room	Hannah Charlotte Interiors	Hannah Goldberg
14	Bluestone Powder Room	Mudroom Powder Room	Laura Rossi Design	Laura Rossi
15	La Dolce Vita	Mud Room	Bernards Decorating	Arlene Reilly
16	Limoncello Laundry	Laundry Room	Lily and the Rose Design	Stephanie Barbara
17	La Femme Den	Recreation Room	Toledo Geller	Virginia Toledo Jessica Geller
18	The Speakeasy at Wildfair	Game Room and Wine Cellar	Mimi and Hill	Miriam Silver Verga Hillary Kaplan
19	Ascending Footsteps	Back Stairs Down & Up	Exceptional Flooring Concepts	Erik Luthy



# MANSION IN MAY®

*designer showhouse and gardens*

2025

SPACE #	TITLE	ROOM	INTERIOR DESIGN FIRM	INTERIOR DESIGNER
20	Memory Lane	Stairs to 2nd Floor wall & Upstairs Left Hallway	Great Brook Gallery	Justine RP Kovacs
21	Five O'Clock Shadow	Courtyard Bedroom & Bathroom	Diane Durocher Interiors	Diane Durocher
22	Be My Guest	Pond View Bedroom	Susan Farcy Interior Design LLC	Susan Farcy
23	Pond View and Petals	Pond View Bedroom Bath	Pam Epifano	Pam Epifano
24	The Country Cloffice	Hallway Walk-In Closet	Timeless Closets & Cabinetry	Wendy Scott
25	Wabi-Sabi Welcome	Second Fl Foyer Hallway	R Brown Interiors	Robyn Brown
26	Pre-Teen Paradise	Left Pondview Bedroom with en-suite Bath	HCO Interiors	Hillary Cohen
27	Mon Boudoir	Middle Pond View BR	RSM Interiors	Robin Mitilenes
28	A Creative Way of Living Nursery	Pond View Sitting Room	ACL Interiors	Ally Lewis
29	Florals in Motion	2nd Floor Back Hallway	LJS Interiors	Lisa Santoro
30	A Mid-Century Night's Dream	Juliet Bedroom & Balcony	Samuel Robert Signature Spaces	Sam Ciardi
31	The Linen Retreat	Rear Hall Closet	MACMom Organizing	Marisa Smith
32	Autumn in Whimsical Woodland	Woodland Bedroom	Jessica Stephans Interior Design	Jessica Stephans
33	Psithurism	2nd Flr Rear Hallway Bath	Tile Lab	Ellie Granieri
34	Garden in the Home	Down Stairs to Hall & Primary Suite	Ahni Kruger Studio	Ahni Kruger
35	The Coffee Bar	Primary Coffee Bar	California Closets	Donna Infantolino
36	Spot on the Clouds	Primary Bathroom	Virtue Tile	Deb Ingersoll
37	Morning Light	Primary Closet	California Closets	Donna Infantolino
38	Spring Fête	Primary Bedroom	C.R. Interior Design	Caitlin Rutkay



SPACE #	TITLE	LANDSCAPE DESIGN FIRM	LANDSCAPE DESIGNER
L1	First Room	AMK Harrington, LLC	Anne Marie Harrington
L6	Soteria, Preservation from Harm	Broadfoot and Broadfoot, LLC	Scott A. Broadfoot Sean Holzli
L1	First Room	Classic Home & Garden	Karen Waldron
L4	Serenade Garden	Country Mile Gardens	Erik Maietta Dan Gallo Jennifer Thomas
L5	Re-Wilding	The Country Nursery	Jodie Freeland Chris Jr. Backshall
L8	Walnut Woodland	Dream Green Design Landscape Architecture	Kevin Bielik Taylor Lasorsa
L1	First Room	Foerster Landscape	Tim Foerster Peter Forenza
L7	Chasing Serenity	Garden Cottage	Sarah Conine Beth Rosevear
L9	Beyond the Wild Foxes	Kohut and Son, Landscape Service	John Kohut
L3	Cocktails and Contemplation	Leaf & Line, Inc.	Dan Chomuk
L7	Chasing Serenity	Limbach's Landscaping	Pete Houghton Tim Ghiselli
L2	Wildfair - After Dark	NatureScape Lighting + Audio	Michael Deo Zac Karr
L3	Cocktails and Contemplation	Square Acre Studio, LLC	Tom Salaki Elizabeth Fontaine





# WOMEN'S ASSOCIATION MORRISTOWN MEDICAL CENTER

## ABOUT THE WOMEN'S ASSOCIATION FOR MORRISTOWN MEDICAL CENTER

Established in March 1893, the Women's Association for Morristown Medical Center (WAMMC) has been pivotal in providing financial support to the hospital, part of the Atlantic Health System. With over 450 dedicated volunteers, WAMMC hosts numerous fundraising events highlighted by the Mansion in May. The association also manages the hospital's gift shops, The Bargain Box Thrift Boutique and WAMMC Network TV, an innovative in-house family television service for young patients. As the volunteer fundraising arm of the Foundation for Morristown Medical Center, WAMMC provides support for capital modernization and expansion, pioneering clinical programs, breakthrough research and ongoing clinical education, contributing over \$32 million to date. For more information, visit [www.wammc.org](http://www.wammc.org).



## MANSION IN MAY<sup>®</sup> *designer showhouse and gardens*

is the signature fundraising event for the Women's Association for Morristown Medical Center with the last mansion attracting over 20,000 visitors.

*WILDFAIR will be the 21th Mansion in May.*

### PAST MANSIONS

- 1974 - Upton Pyne, Bernardsville
- 1976 - Giralda, Madison
- 1980 - Schiff Estate, Mendham
- 1981 - Hollow Hill Farm, Convent Station
- 1986 - Evergreens, Morristown
- 1988 - Warren Estate, Bernardsville
- 1991 - Upton Pyne, Revisted, Bernardsville
- 1994 - Bayley - Ellard, Madison
- 1997 - Vail Mansion, Morristown
- 1999 - Knox Hill, Morris Township
- 2001 - Ellerslea, Morris Township
- 2003 - Cross Estate, Bernardsville
- 2006 - Ross Family Farm, Basking Ridge
- 2008 - Froh Heim, Far Hills
- 2010 - Fawn Hill Farm, Harding Township
- 2012 - Glynallyn, Morristown
- 2014 - Blairsden, Peapack-Gladstone
- 2017 - Alnwick Hall - The Abbey, Morris Township
- 2020 - Tyvan Hill, Harding Township
- 2023 - Three Fields, Borough of Mendham



*Contributing with Passion for over 130 Years*



Photos of the excitement of the Media Open House are captured in the following Photo Library. Each File depicts the photographer that should receive photo credit: **North Jersey Drone Shots** or **Heather Swartz**.

**[Media Open House Photo LINK](#)**